

Beamever

NOVA TAPE

Dot-free, flexible,
cuttable and dimmable tape.
Pre-wired tape, simple and
quick installation.

Easy to mount on smooth
surfaces thanks to high quality
3M tape at the back.

One BIN Only to ensure perfect
color consistency



Beamever



NOVA TAPE

- Almost dot-free itself, which offer you great freedom of choosing profile.
- High lumen and fancy looking by the unique design.
- Wide color temperature range for your option.
- Long lifespan and excellent in heat dissipation.
- Use COB chips in One BIN Only to ensure perfect color consistency.
- High CRI90 to present real color, CRI80 is optional to meet your different needs.

Product Benefits:

- Flexible, cuttable and dimmable LED strip.
- Easy to mount on smooth surfaces thanks to high quality 3M tape at the back.
- Pre-wired LED strip, simple and quick connection.

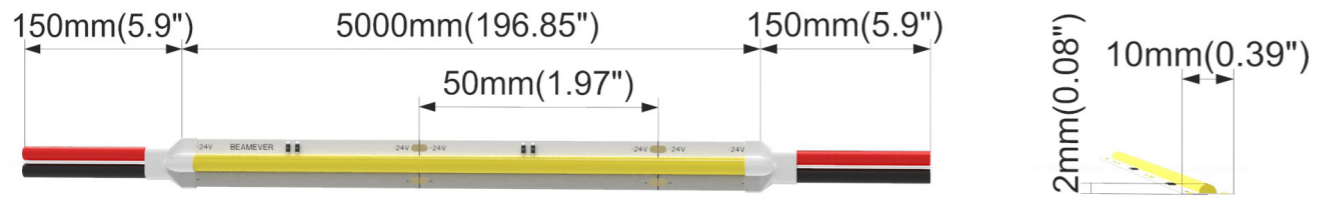

Electrical data

Voltage	DC24V (23.5V _{min} 24.5V _{max})
LED PIN Temperature	Max. 60.9°C /141.6°F
Storage Temperature	-25°C /-13°F _{min} 60°C /140°F _{max}
Lumen Efficiency	110lm/w(4000K)
SDCM	3 (2700K, 3000K, 4000K)
Ra	Ra90; Ra80 optional
Max Current/LED	26mA
Unit Cut	50mm
Waterproof Rate	IP20
Warranty	5 Years

LM/M	5W	10W	15W
2700K	510	950	1380
3000K	550	1000	1480
3500K	590	1090	1500
4000K	627	1105	1600
6500K	600	1100	1620
Max. Run Length(M)	5	5	5

Indoor

Life span > 54000H

One Bin Only

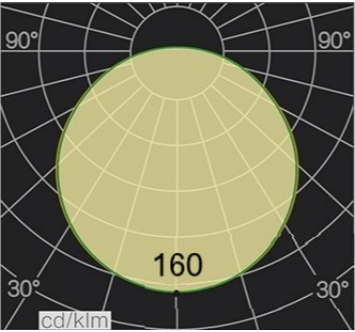

Important notice

-The given data are typical values due to the tolerances of the production process and the electrical components, values for light output and electrical power can vary up to 10%.

Order code

SERIES NAME	COLOR	LENGTH	POWER
NOVA TAPE	27= 2700K	05000=5M/196.85"	050=5W
	30= 3000K		100=10W
	35= 3500K		150=15W
	40=4000K		
	65=6500K		

Eg1:
NOVA TAPE-27-05000-050:
NOVA TAPE, 2700K, 5M/reel,
5W/m.

Eg2:
NOVA TAPE-30-05000-100:
NOVA TAPE, 3000K, 5M/reel,
10W/m.

Accessories

Art.#	Description	Picture	Art.#	Description	Picture
C0011	Connector for Strip to strip connection, IP20		T0001	VHB 3M adhesive tape	
C0012	Connector for Strip to strip connection, IP20		XLG-150-24-A	PSU 24V/150W IP67, Non-dimmable, White, 100-305V supply	
MF001	Male and Female connector, IP20		ELG-150-24B	PSU 24V/150W IP67, 3 in 1 dimming function, White, 100-305V supply	
MF002	Male and Female DC connector, IP44		ELG-150-24DA	PSU 24V/150W IP67, DALI control technology, White, 100-305V supply	

Wiring connection

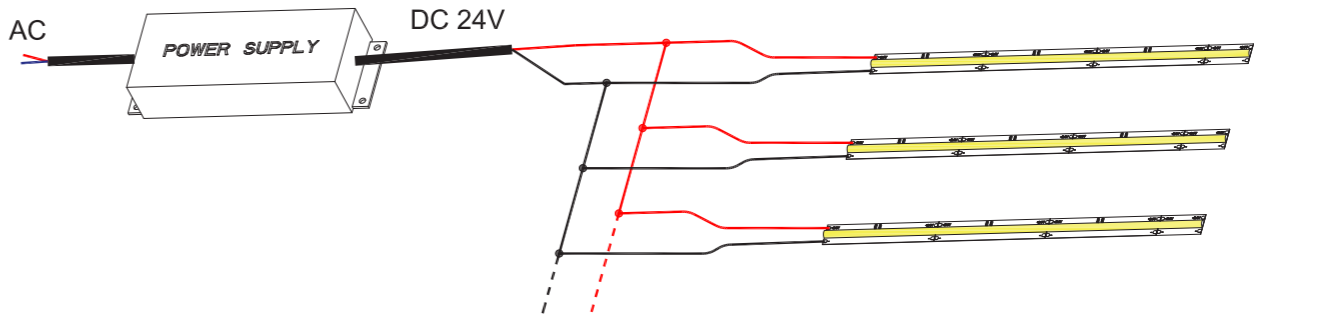

Application

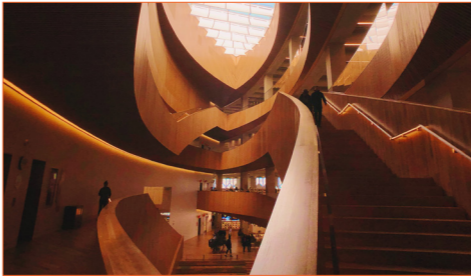

Where to use the product?

It can create impressive dot-free light, effectively and elegantly highlighting certain areas with charming lighting and bringing your project to light. Its excellent flexibility and cuttability offer many possibilities and great freedom of design. Full color range to meet your different lighting needs.

This is an awesome lighting product for all interior applications for commercial, residential, architectural, and decorative purposes. Let’ s bring your project to charming light. You can use it in restaurants, airports, corridors, shopping malls, and hotels.....countless application places, open up your imaginations !!!





Beamever

Address: 100 N Howard St Ste R,
Spokane, WA, 99201-0508 USA
Tel: 323-5104660
info@beamever.com
www.beamever.com